

Atelier Sibylle Pasche



Zurich, February 26th, 2014

Atelier Sibylle Pasche
Auf der Burg 12
CH-8706 Meilen (ZH)
Switzerland
T +41 44 380 39 16
M +41 79 708 97 32
sibylle.pasche@bluewin.ch
www.sibyllepasche.ch
www.facebook.com/sibyllepasche

YL XinYi residency Taipei, 2014

Project proposal / Concept by Sibylle Pasche 2014

BIRTH and GENESIS

I would like to propose two solitary standing sculptures, both unique pieces obviously, for the two different garden areas located south and north in front of the two buildings. I worked out this unique project, composed of two pieces complementing each other, especially for YL XinYi residency. Both works will be quite voluminous and large-scale dimensioned, with a diameter of about 2m. They will be realized in stone, more precisely in prestigious white Carrara marble from Italy (a material used in art and architecture already since the Roman times to Renaissance artist such as Michelangelo and recently again and likely used by contemporary artist) - a beautiful bright and shining marble with a crystalline texture, scintillating in the sunlight and bright shining, apparently from inside, during nights. Because of this material, their weight will be quite considerable and around 8 tones each. But with an invisible concrete basement underneath, the weight can be distributed in order to keep the weight restriction limit of the top of the basement parking area. In my opinion it is very important that the objects have a certain dimension and are not too small, in order to be competitive with the spacious surrounding area and the impressive twin tower buildings growing vertically to the sky.

The round shape of my sculptures, expanding usually in width and not - as most often in sculpture - in height, along with their bright white shining and warm color, will embody a refreshing and pleasant contrast to the amazing architecture of the towers, together with the beautiful and peaceful Japanese Zen meditation garden created by Mr. Horiguchi.



The common theme of the two objects related to nature and its constant coming into being and passing away, would point out in a wonderful way the togetherness of the two twin towers and create unity of the entire new built area. Being inspired by the concept of the mediation garden, both objects will be kind of natural boulders, such as 'meditation stones', while radiating both harmony and silence. The two generously proportioned and softly shaped objects will become naturally part of the landscape, as a symbol reminding mother earth to be on spot in the middle of an enormous metropolis. The sculptures will have a strong archaic presence, lying there apparently since ever and transmitting warm energy and earthbound power. They can be touched and experienced by the people walking through the garden.

'Nodo' is the Italian word for 'ribbon', 'knot', 'node', but means also 'Alpha and Omega' – the beginning and the end, - genesis. The organic shape of 'Nodo' is rhythmically bounded and reminds somehow a cocoon. 'Nascita' (translated 'birth') is kind of a fertility symbol, reminding the incurrence of new life. It is composed of different partial volumes, growing out of its main body. The shape seems therefore to be in constant change.

In both works materiality becomes a totally new expression/meaning. The hardness and heaviness of the stone fades into the background while the volumes appear gentle and soft, the curves well-rounded, the surface smooth. There is no flat bottom to define its stand space, but the objects seem to take off while balancing on three points of contact only. The huge physical weight of the sculptures seems apparently to disappear. There is no clear above and beneath and no main view, which is very important for this site-specific installation. It allows people to experience all sides of the sculptures from all the different possible perspectives, even from above.

'Nodo' is a brand new sculpture and already realized, while 'Nascita' does not yet exist, but just as a small model to illustrate the idea of the second complementing piece for the YL XinYi residency project. The realization of the large-scale sculpture in my studio in Carrara/Italy just started and work is in progress as you can see from the pictures bellow. I can't wait to see both pieces together or related to each other and it would be wonderful to do so in occasion of this project in Taipei.

I consider this project a meaningful and poetic add-on to the garden area designed by Mr. Horiguchi and a powerful but at the same time warm and gentle way of contrasting the straight-line architecture of the two buildings

N°	Picture	Dimension (H x L x W) height x length x width	Location	Price Swiss CHF
1		Nodo Marble Bianco Carrara 150 x 210 x 205 cm 2012/2013 8 t	Garden building north	90'000.-
2		Nascita Marble Bianco Carrara 170 x 212 x 197 cm 2014/2015 8-9 t work in progress.....	Garden building south	about 100'000.- (final price by end of the realization) Modell 1:6 28,5 x 36 x 32 cm

Transportation / Installation

The costs for transportation and the installation with the crane on the site is not included in the retail price above, but will keep within budget. For the shipment one entire 25t-container will be needed.

Nodo



Visualization garden building north

Nodo, Marble Bianco Carrara, 150 x 210 x 205 cm, 2012/2013

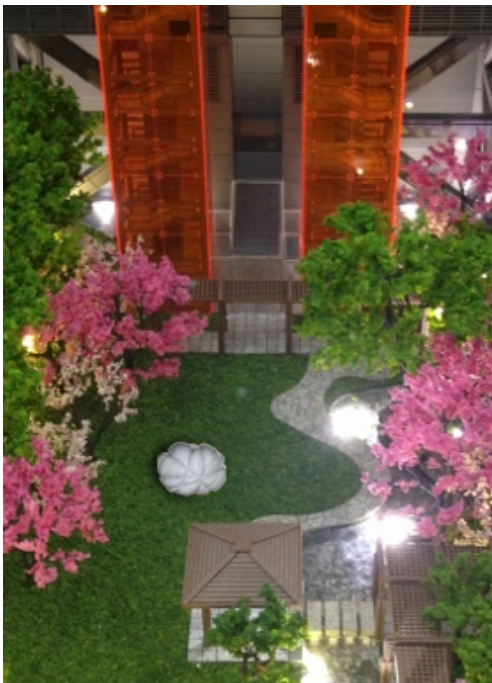

Nascita



Visualization garden building south

Nascita, Marble Bianco Carrara, 170 x 212 x 197 cm, 2014/2015

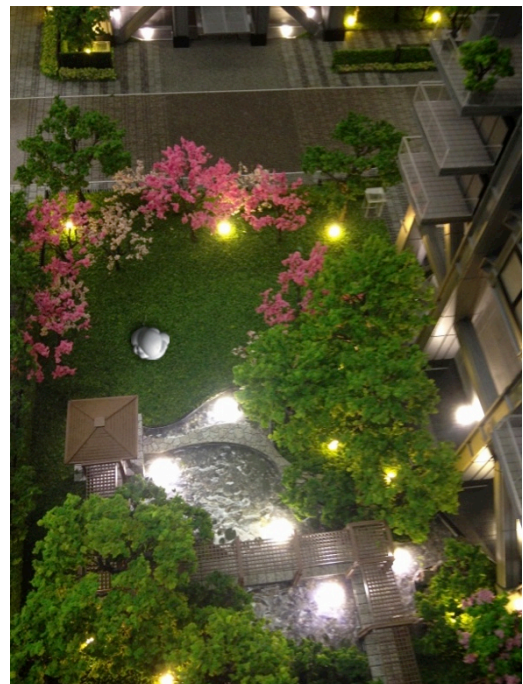
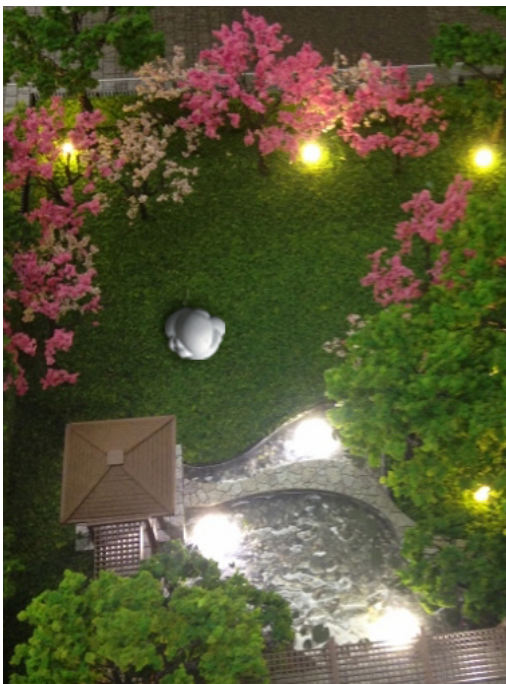

Visualization garden building south

Nascita, Marble Bianco Carrara, 170 x 212 x 197 cm, 2013/2014



Realization (work in progress) of sculpture ,Nascita'

Nascita, Marble Bianco Carrara, 170 x 212 x 197 cm, 2013/2014

At my sculpture studio in Carrara (Italy), 'Nascita' is now roughly cut out of the block. The work will continue as soon as the decision of YL XinYi is made. The entire work will take about 5-6 month and the pieces could be ready by the end of 2014.



